

Draufsicht

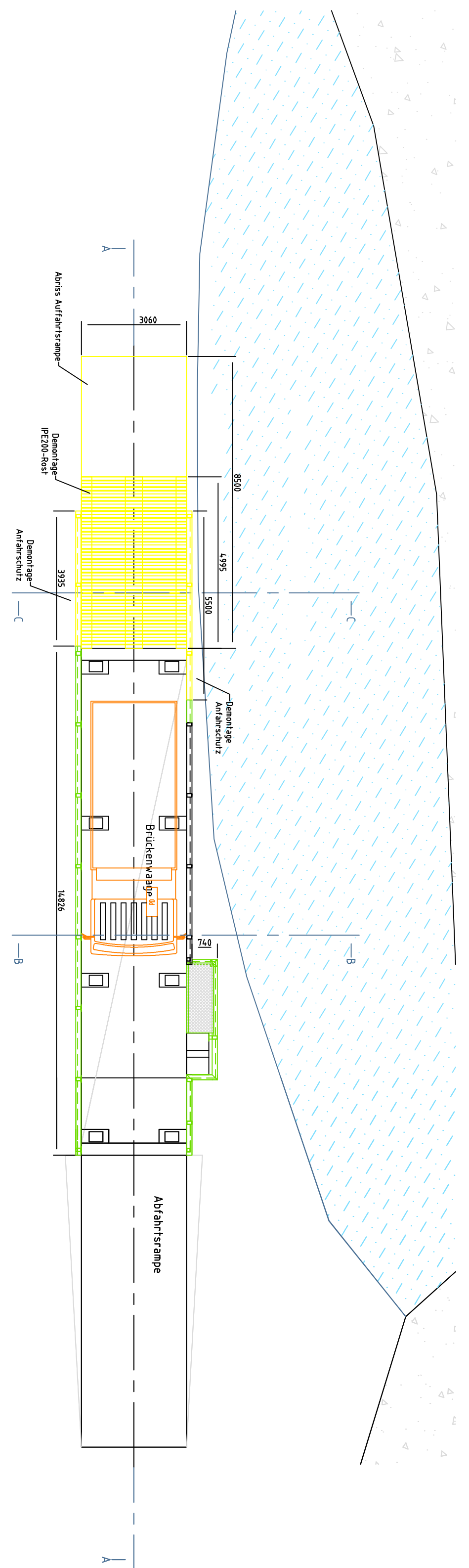

Schnitt A-A

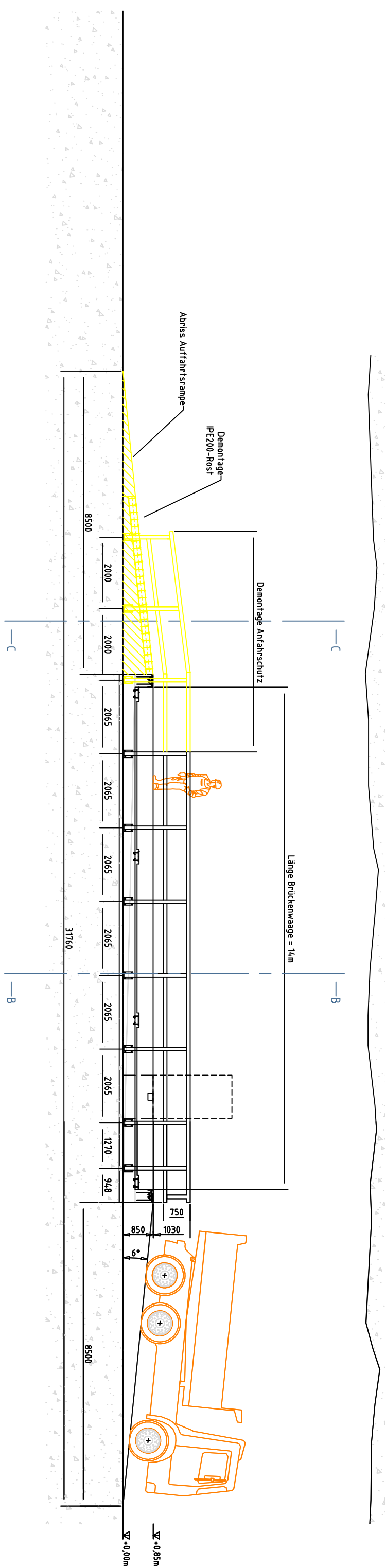

Schnitt B-B

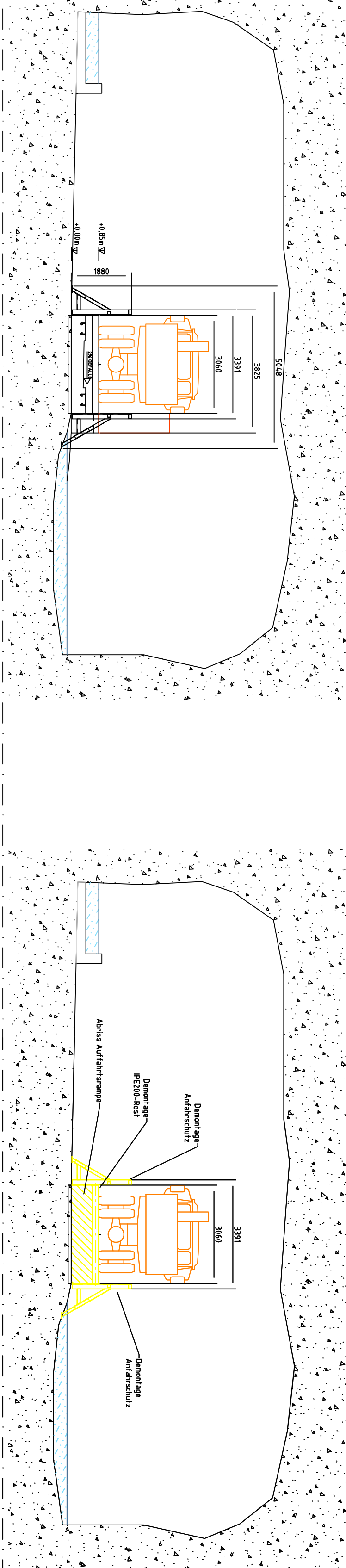

Draufsicht

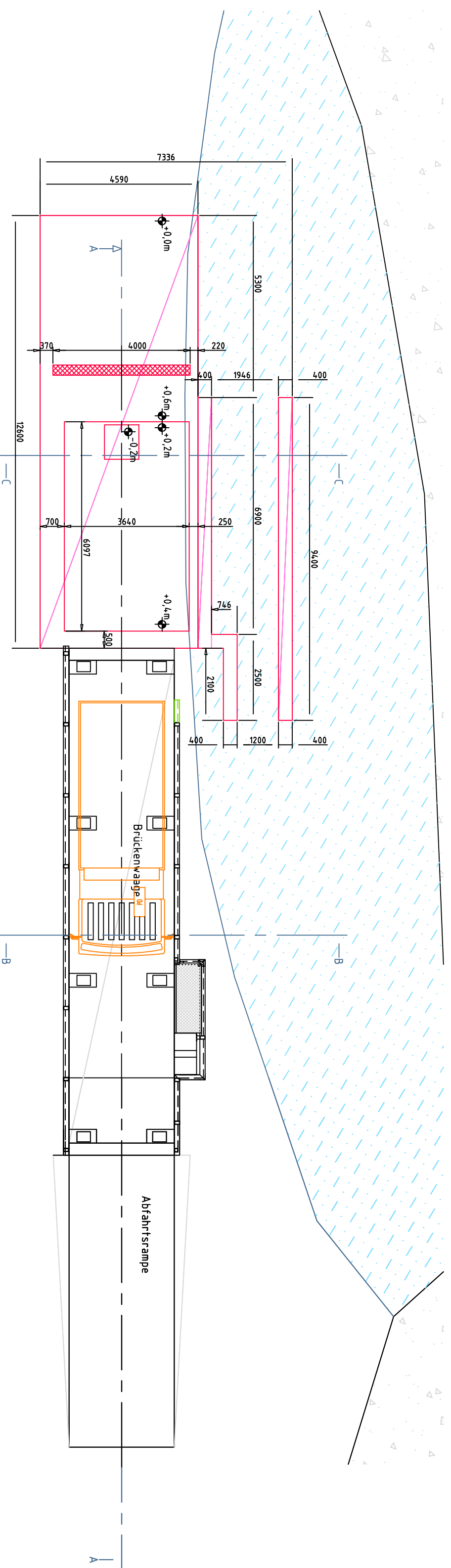

Schnitt A-A

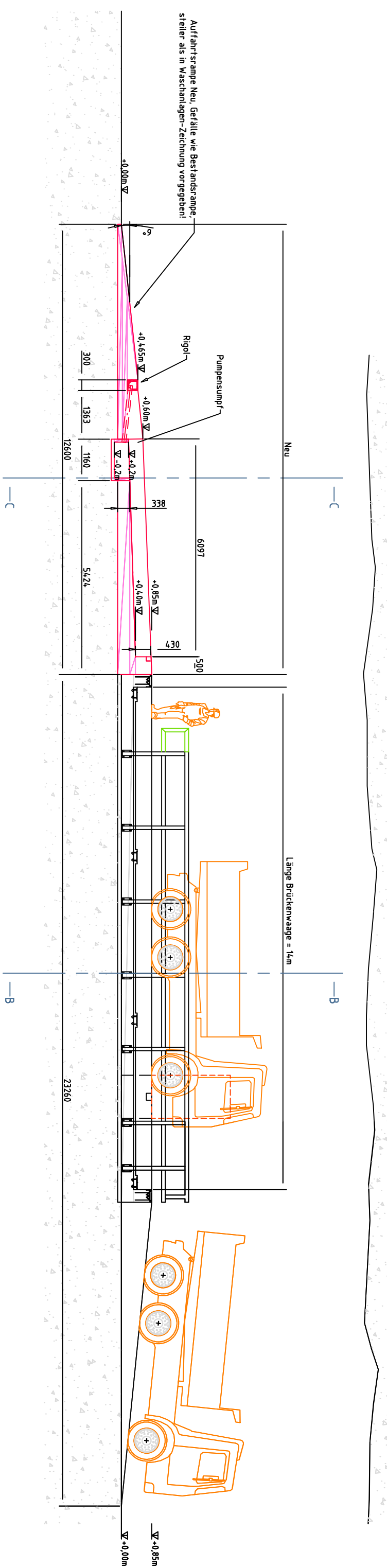

Schnitt B-B

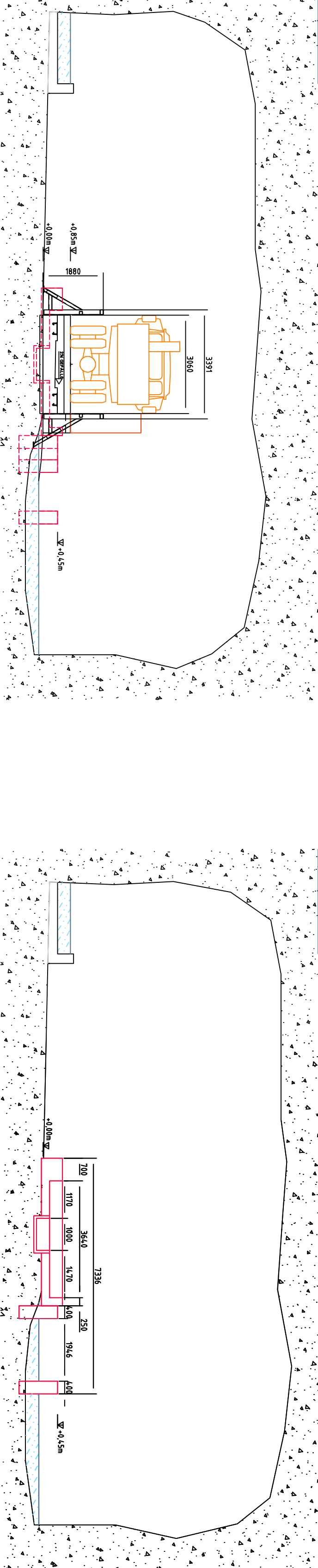

Draufsicht

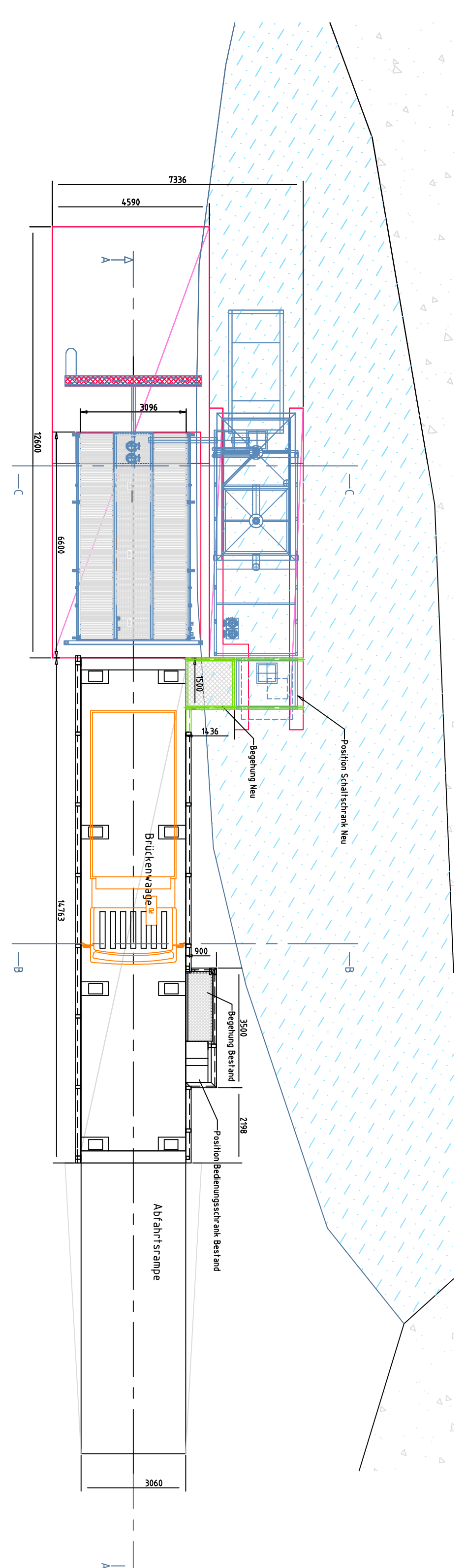

Schnitt A-A

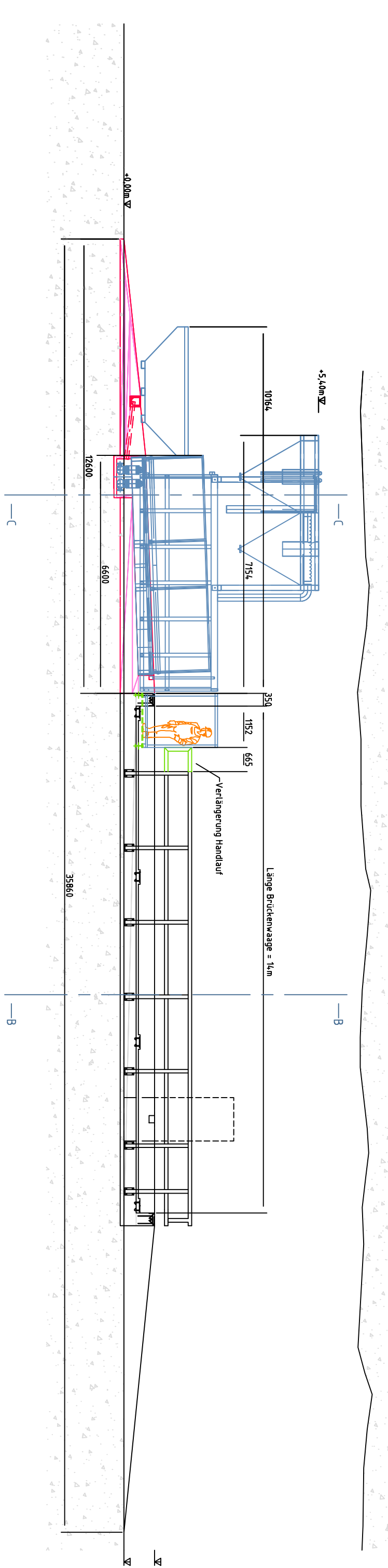

Schnitt B-B

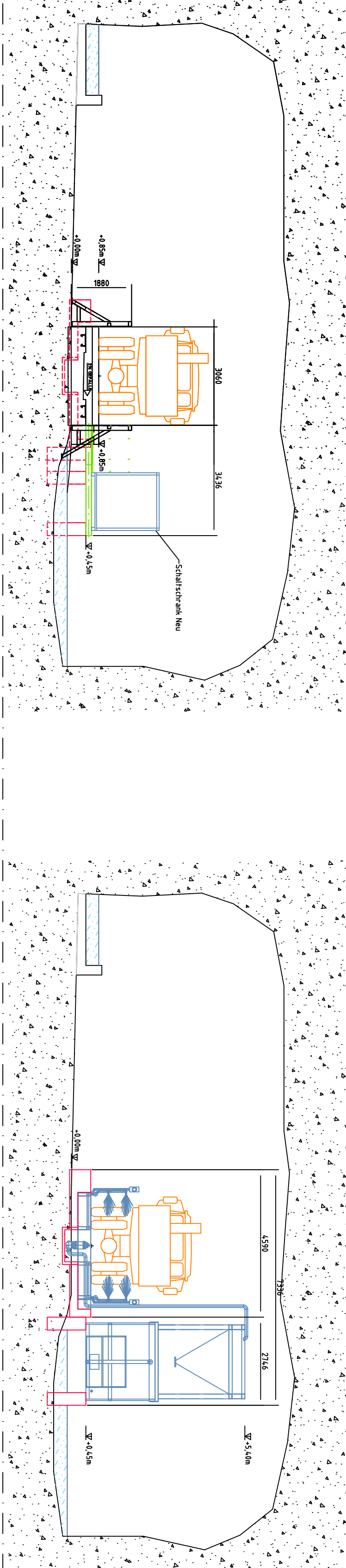

Draufsicht

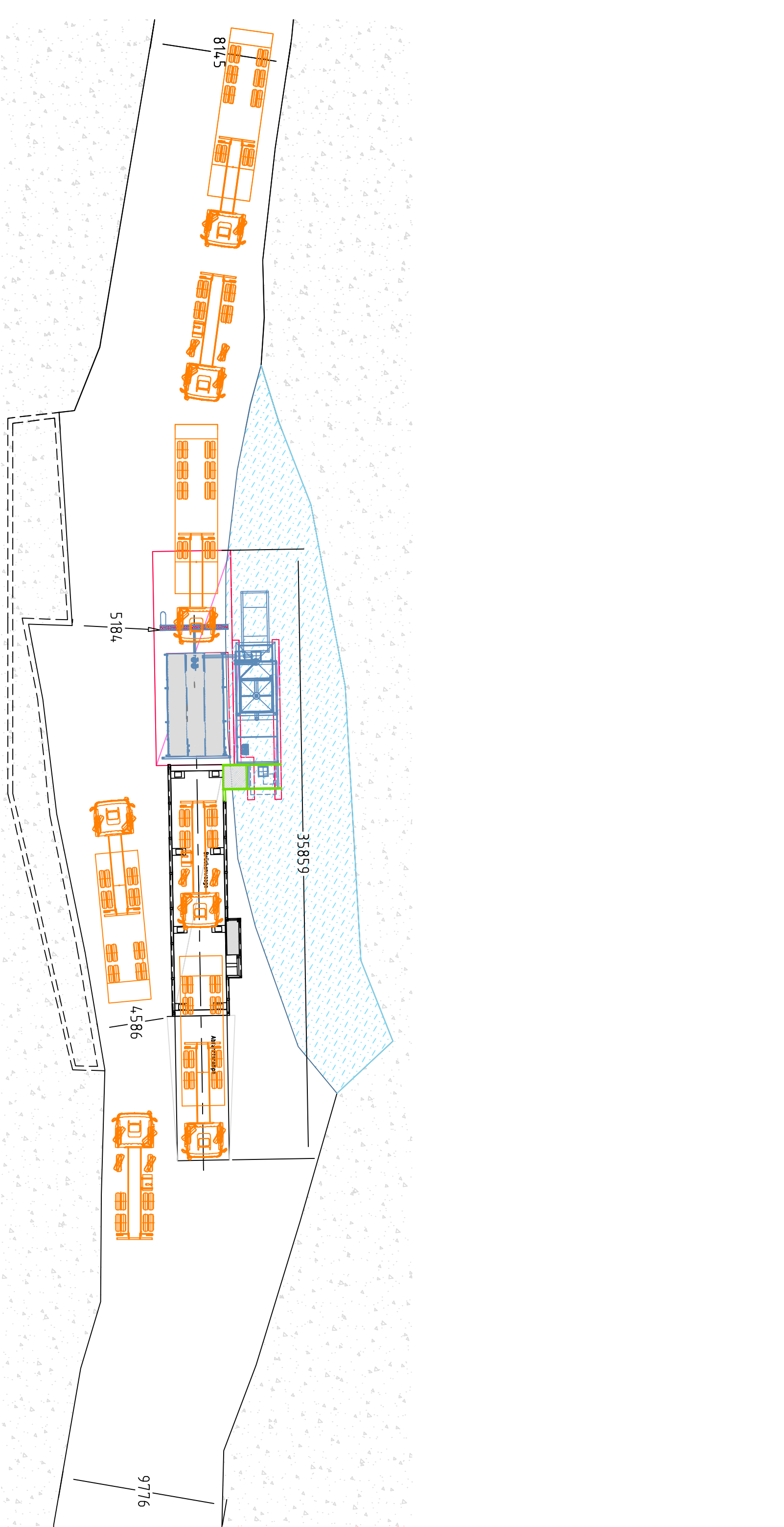

- ▭ Installationen Neu
- ▭ Fundamente Neu
- ▭ Abriss

Anlage 5.11
Lageplan Lkw Waschplatz Pardoun

11	-	-	-
10	-	-	-
9	-	-	-
8	-	-	-
7	-	-	-
6	-	-	-
5	-	-	-
4	-	-	-
3	-	-	-
2	04	Drainage	04/08
1	01	Drainage	01/08

1004 - Stiering / Vepieno	1:100	Geologie & Geoinformation
LKW - Waschanlage Pardoun	CAD	A-9722 CUMMER/WILLAGH
20.04.2017	WZ	